



Lexie Hearing Aids Powered by Bose

RECEIVER WIRE
REPLACEMENT GUIDE

POWERED BY
BOSE

We're here to help.



For help,
call (800) 499-1336 and speak
to a Lexie Expert[®] or go to
lexiehearing.com/us/support

What you need:



Receiver
wire

+



Hearing aids



Dome kit
(optional)

Step 1:

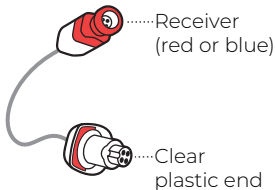

Identify the two ends of
the receiver wire.

Step 2:

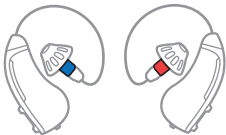

On the hearing aids, find the old receiver wire that has the same color speaker as the new cable (red or blue).

Step 3:

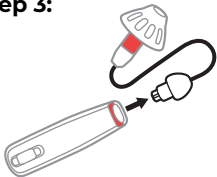

Grip the wider end of the receiver wire where it connects to the body of the hearing aid and firmly pull it off.

Note: You may have to pull harder than expected. Do not pull on the wire itself. This will cause the wire to stretch and break over time.

Step 4:

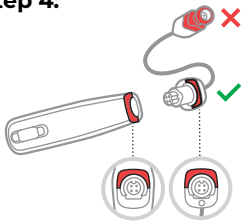

Align the clear plastic end of the new receiver wire with the port on the hearing aid body so the red or blue marks line up.

Step 5:

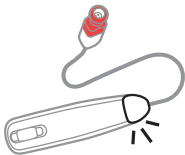

Insert the receiver wire into the hearing aid body until you hear or feel a click.

Step 6:

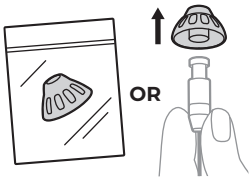

Get a dome for the new receiver wire. Either pick your size from a dome kit (available separately) or firmly pull the dome off of the old receiver wire.

Step 7:

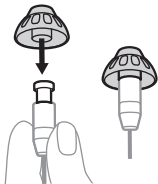

On the new receiver wire, align the opening of the dome with the receiver and slide the dome onto the receiver.

Step 8:



Gently tug the dome to make sure it's securely fastened.

Note: This helps prevent the dome from falling off in your ear canal.



Copyright © 2016-2024
hearX USA Inc.